



04_TRANSPORTATION AND INFRASTRUCTURE

Ski Station

Rail



Illustration of Ski Station seen from travel plazas on the east side of the railway | Ill.: Multiconsult and LINK Landscape

Multiconsult, with LPO Arkitekter and LINK Landskap as its subcontractors, has prepared zoning and detailed plans for the new Ski Station.

The company has also prepared tender documents for a turnkey contact based on the national services catalogue (NTK) standard. This contract also covers about four kilometres of open-air railway line. The project embraces platforms with underpasses, substructure with technical railway components and guideways, technical, service and personnel buildings, a new Nordbyveien overpass, bus terminal and parking for rail users. The open-air stretch contains large concrete structures, concrete portals for the Follo Line, a freight-track tunnel and technical buildings. In addition, the project includes extensive preparatory work for readying the project site for a turnkey contractor.

PROJECT
Ski Station

PROJECT TYPE
Zoning plan, detailed plan and tender documents for a turnkey contract

LOCATION
Ski local authority in Akershus county

CLIENT
Norwegian National Rail Administration, construction projects

TIME PERIOD
2006 - 2007 | 2009 - 2014

KEY NUMBERS
Estimated project cost: about NOK 3 billion. Construction start in 2015

SCOPE OF WORK

The assignment has been conducted with all disciplines located together in close cooperation with the National Rail Administration.

A staged methodology has been utilised for managing the assignment. Together with other management tools, this ensures control of costs, progress and deliveries.

During the design process, a number of studies, analyses and plans are produced as the basis for designing solutions. These include:

- Safety, health and the working environment analyses
- Reliability, availability, maintainability and safety (RAMS) analyses
- Policy documents
- Failure mode and effects analysis (FMEA) for water and drainage facilities
- Identification of hazards and of reliability, availability and maintainability (RAM)
- Vibration from trains

Tender documents for a turnkey contract covering Ski Station and the open-air section will be developed under the National Rail Administration's consultancy contract – the Follo Line Project Service Agreement.

OUR SERVICES

- Site preparation
- Planning
- Design
- Structural engineering
- Landscaping
- Architecture
- Highway engineering
- Water, drainage and district heating
- Electrical engineering
- Geotechnology
- Fire precautions
- Noise abatement
- Traffic
- Environmental protection
- Safety, health and the environment
- Reliability, availability, maintainability and safety (RAMS)
- Cost estimates
- Analyses
- Environmental clearance
- 3D modelling

DISCIPLINES

- Zoning
- Detailed plan
- Tender documents for turnkey contract

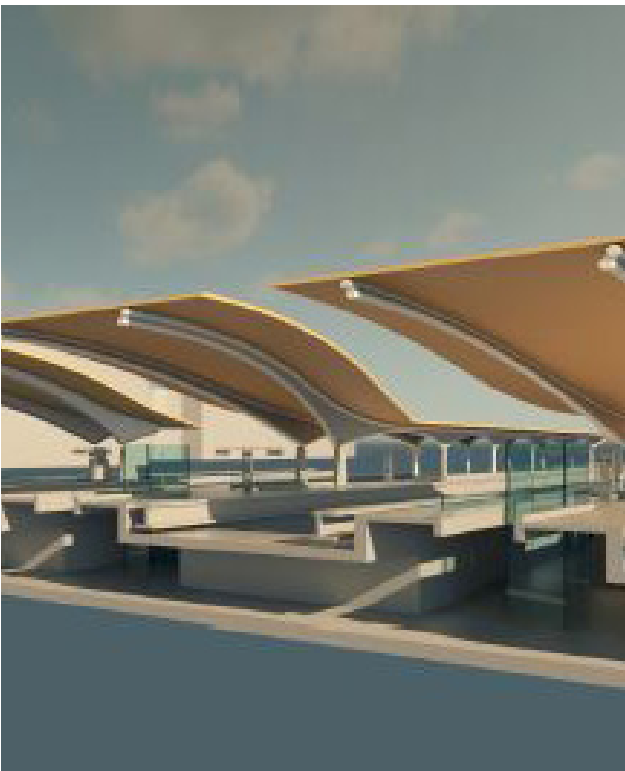

Illustration of platforms and plattformtak | Ill: Multiconsult and LPO



Illustration of Nordbyveien bridge | Ill: Multiconsult and LINK Landscape

IT 104_000, rev. 12.10.2016